

3-Way Rotary Lock-out / Tag-out Valve

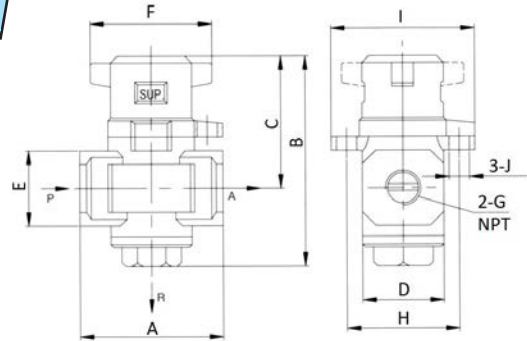

Dimensions (mm)

Model No.	G	Exhaust Port	A	B	C	D	E	F	H	I	J	List Price
RLT2-2P	1/4	1/8	40	59	39	28	22	40	32	41	6	\$ 28.75
RLT3-3P	3/8	1/4	53	78	49	30	28	45	41.5	53	7.5	\$ 35.45
RLT4-4P	1/2	3/8	70	84	52	36	36	45	41.5	53	7.5	\$ 47.05

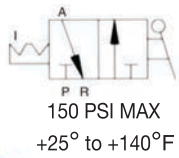
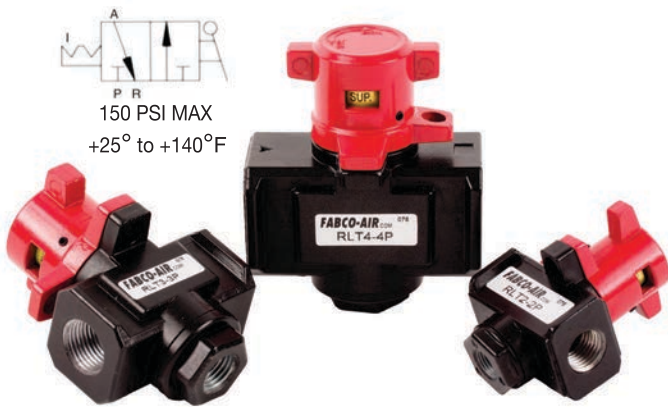

This manually operated valve is used to prevent operation. When in exhaust position, the valve can be locked out to prevent accidental start-up's. Can be connected to FRL components with NPT port or manifold interface items. Note: Use of the accessory "T" interface adjacent to these items may interfere with rotary lock-out action.

Quick Exhaust Valve

Increase cylinder speed and reduce cycle times by purging cylinder exhaust quickly.

The **FKP** quick exhaust valve can be used with most **FABCO** pneumatic cylinders.

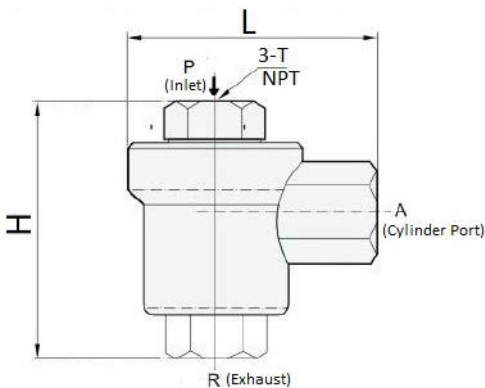

Dimensions (mm)

Model No.	Port Size T	H	L	List Price
FKP-06	1/8	37	41.5	\$14.65
FKP-08	1/4	51	45	\$16.80
FKP-10	3/8	68	62	\$22.90
FKP-15	1/2	77	86	\$26.80

